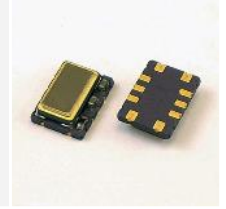

CERAMIC SMD TCXO / VCTCXO (7.0 x 5.0 x 2.0mm)
FEATURES

- HIGH STABILITY UP TO $\pm 0.05\text{ppm}$
- LOW PHASE NOISE
- USED FOR **FEMTOCELL** APPLICATION

■ SPECIFICATION

PARAMETER		MIN.	TYP.	MAX.	UNIT	NOTE	
FREQUENCY RANGE		5		40	MHz		
STANDARD FREQUENCIES	CMOS	5M, 6.4M, 8.192M, 10M, 12.5M, 12.8M, 16M, 16.384M, 19.44M, 25M					
	CSW	8.192M, 10M, 12.5M, 12.8M, 16M, 16.384M, 19.44M, 25M					
FREQUENCY TOLERANCE				± 2.0	ppm		
FREQUENCY STABILITY	vs. TEMPERATURE RANGE	± 0.05		± 0.5	ppm	See P/N guide for other options	
	vs. LOAD $\pm 10\%$			± 0.2	ppm		
	vs. SUPPLY VOLTAGE $\pm 5\%$			± 0.5	ppm		
	vs. AGING			± 1.0	ppm		
OPERATING TEMPERATURE RANGE		-40		+85	$^{\circ}\text{C}$	See P/N guide for other options	
STORAGE TEMPERATURE RANGE		-55		-125	$^{\circ}\text{C}$		
SUPPLY VOLTAGE $\pm 5\%$		3.3		5.0	V		
SUPPLY CURRENT	CMOS			6	mA		
	CSW			3.5	mA		
OUTPUT	LOAD	CMOS	15pF				
		CSW	10k Ω //10pF				
	LEVEL	CMOS (V_{OH})	$V_{DD} \times 0.90$			V	
		CMOS (V_{OL})			$V_{DD} \times 0.10$	V	
		CSW	0.8			V_{P-P}	
	SYMMETRY (DUTY CYCLE)		45		55	%	For CMOS
	RISE AND FALL TIME (T_r/T_f)				10	nS	For CMOS
	START-UP TIME				2.0	mS	
STAND-BY VOLTAGE	ENABLE (V_{IH})	$0.7 \times V_{DD}$			V		
	DISABLE (V_{IL})			$0.3 \times V_{DD}$	V		
FREQUENCY DEVIATION		± 5.0		± 12.0	ppm	See P/N guide for other options	
CONTROL VOLTAGE		0.5		2.5	V		
V_c INPUT IMPEDANCE		100			k Ω		
PHASE NOISE	100Hz			-120	dBc/Hz	@ 12.8MHz	
	1kHz			-140	dBc/Hz		
	10kHz			-148	dBc/Hz		

Transko Electronics, Inc reserves the right to make changes to the product (s), service (s), and specification (s) described herein without notice. See "Terms of Sale" for details on our website.

PACKAGE DIMENSIONS

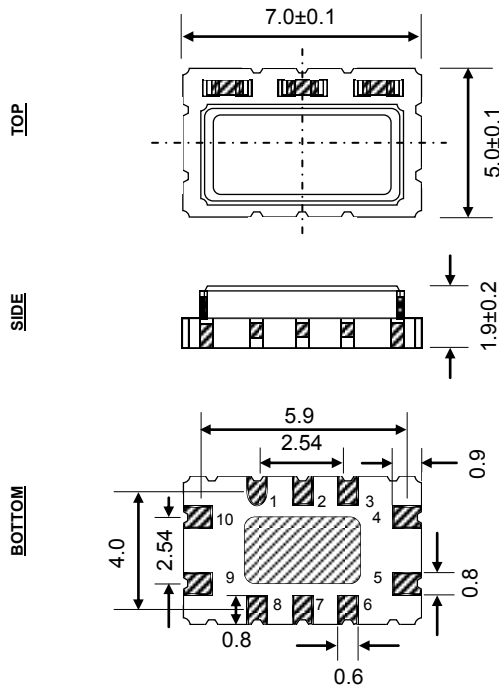

SOLDER PATTERN

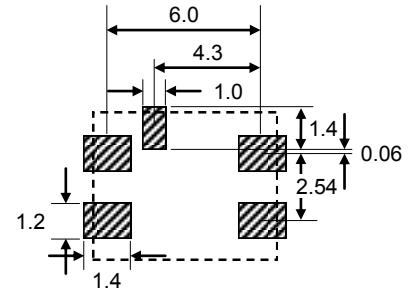

REFLOW PROFILE

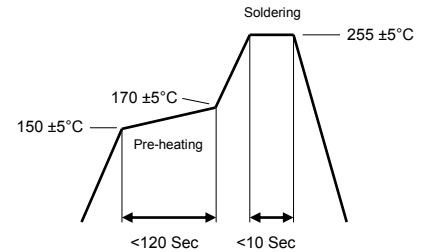

PART NUMBERING GUIDE

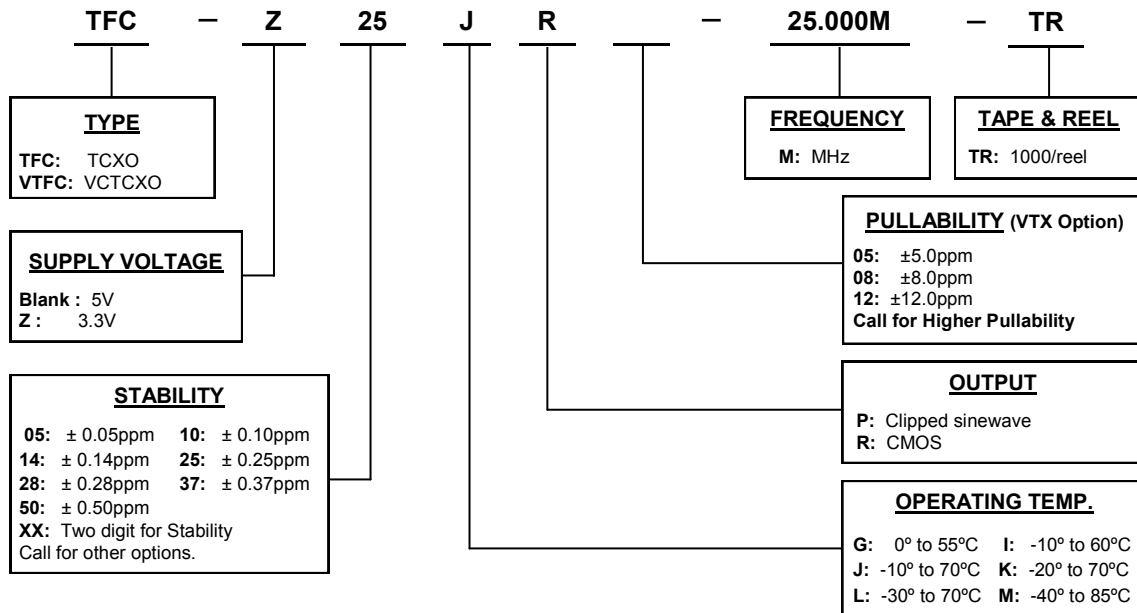

Transko Electronics, Inc reserves the right to make changes to the product (s), service (s), and specification (s) described herein without notice. See "Terms of Sale" for details on our website.